

Licensing Act 2003

Premises Licence**LEIPRM0004**Leicester
City CouncilLocal Services & Enforcement
Leicester City Council
York House
91 Granby Street
Leicester
LE1 6FB(0116) 4543040
licensing@leicester.gov.uk

Part 1 - Premises Details

POSTAL ADDRESS OF PREMISES, OR IF NONE, ORDNANCE SURVEY MAP REFERENCE OR DESCRIPTION

Off Licence - Chrystal News

10 Hannam Court, Charles Street, Leicester, LE1 3FS.

WHERE THE LICENCE IS TIME LIMITED THE DATES

Not applicable

Expires **no expiry**

LICENSABLE ACTIVITIES AUTHORISED BY THE LICENCE

- the supply of alcohol

THE TIMES THE LICENCE AUTHORISES THE CARRYING OUT OF LICENSABLE ACTIVITIES

Activity (and Area if applicable)	Description	Time From	Time To
J. Supply of alcohol for consumption OFF the premises only	Monday to Sunday	6:00am	10:00pm

THE OPENING HOURS OF THE PREMISES

Description	Time From	Time To
Monday to Sunday	6:00am	10:00pm

WHERE THE LICENCE AUTHORISES SUPPLIES OF ALCOHOL WHETHER THESE ARE ON AND / OR OFF SUPPLIES

- J. Supply of alcohol for consumption OFF the premises only

Part 2

NAME, (REGISTERED) ADDRESS, TELEPHONE NUMBER AND EMAIL (WHERE RELEVANT) OF HOLDER OF PREMISES LICENCE

Nikita Enerprises Ltd

129 Rosemead Drive, Oadby, Leicester, LE2 5PP.

REGISTERED NUMBER OF HOLDER, FOR EXAMPLE COMPANY NUMBER, CHARITY NUMBER (WHERE APPLICABLE)

Nikita Enerprises Ltd

8349716



Licensing Act 2003

Premises Licence

LEIPRM0004



Leicester
City Council

Local Services & Enforcement
Leicester City Council
York House
91 Granby Street
Leicester
LE1 6FB

(0116) 4543040
licensing@leicester.gov.uk

NAME, ADDRESS AND TELEPHONE NUMBER OF DESIGNATED PREMISES SUPERVISOR WHERE THE PREMISES LICENCE AUTHORISES THE SUPPLY OF ALCOHOL

Chimanlal Bhaichandbhai SHAH



PERSONAL LICENCE NUMBER AND ISSUING AUTHORITY OF PERSONAL LICENCE HELD BY DESIGNATED PREMISES SUPERVISOR WHERE THE PREMISES LICENCE AUTHORISES FOR THE SUPPLY OF ALCOHOL

Licence No. OWPS0007

Issued by Oadby and Wigston

ANNEXES

Annex 1 - Mandatory conditions

No supply of alcohol may be made under the premises licence - a) at a time when there is no designated premises supervisor in respect of the premises licence, or b) at a time when the designated premises supervisor does not hold a personal licence or his personal licence is suspended.

Every supply of alcohol under the premises licence must be made or authorised by a person who holds a personal licence.

Annex 2 - Conditions consistent with the operating schedule

Alcohol shall not be sold or supplied unless it is paid for before or at the time when it is sold or supplied.

The above restriction does not prohibit any sale, supply or consumption of alcohol previously permitted by the Licensing Act 1964.

Alcohol shall not be sold in an open container or be consumed in the licensed premises.

Annex 3 - Conditions attached after a hearing by the licensing authority

None



PLANE OF CRYSTAL NEWS
10, HANNAM COURT
41, CHARL STREET
LEICESTER
LE 1.3 FS.

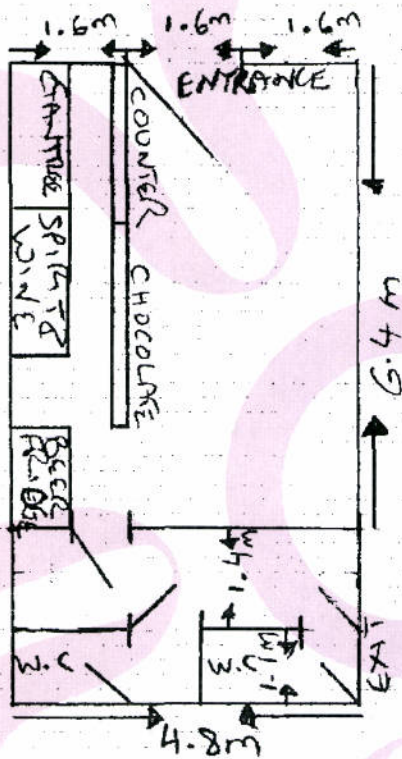

SCALE 1:100



Leicester
City Council

Local Services & Enforcement
Leicester City Council
York House
91 Granby Street
Leicester
LE1 6FB

(0116) 4543040
licensing@leicester.gov.uk

Premises Details

POSTAL ADDRESS OF PREMISES, OR IF NONE, ORDNANCE SURVEY MAP REFERENCE OR DESCRIPTION

Off Licence - Chrystal News

10 Hannam Court, Charles Street, Leicester, LE1 3FS.

WHERE THE LICENCE IS TIME LIMITED THE DATES

Not applicable

LICENSABLE ACTIVITIES AUTHORISED BY THE LICENCE

- the supply of alcohol

THE TIMES THE LICENCE AUTHORISES THE CARRYING OUT OF LICENSABLE ACTIVITIES

Activity (and Area if applicable)	Description	Time From	Time To
J. Supply of alcohol for consumption	OFF the premises only Monday to Sunday	6:00am	10:00pm

THE OPENING HOURS OF THE PREMISES

Description	Time From	Time To
Monday to Sunday	6:00am	10:00pm

WHERE THE LICENCE AUTHORISES SUPPLIES OF ALCOHOL WHETHER THESE ARE ON AND / OR OFF SUPPLIES

- J. Supply of alcohol for consumption OFF the premises only

NAME, (REGISTERED) ADDRESS OF HOLDER OF PREMISES LICENCE

Nikita Enerprises Ltd 129 Rosemead Drive, Oadby, Leicester, LE2 5PP.

REGISTERED NUMBER OF HOLDER, FOR EXAMPLE COMPANY NUMBER, CHARITY NUMBER (WHERE APPLICABLE)

Nikita Enerprises Ltd 8349716

NAME OF DESIGNATED PREMISES SUPERVISOR WHERE THE PREMISES LICENCE AUTHORISES THE SUPPLY OF ALCOHOL

Chimanlal Bhaichandbhai SHAH

STATE WHETHER ACCESS TO THE PREMISES BY CHILDREN IS RESTRICTED OR PROHIBITED



Licensing Act 2003

Premises Licence Summary

LEIPRM0004



Leicester
City Council

Local Services & Enforcement
Leicester City Council
York House
91 Granby Street
Leicester
LE1 6FB

(0116) 4543040
licensing@leicester.gov.uk

